

WATER MAIN DETAIL "C"
1" = 30'

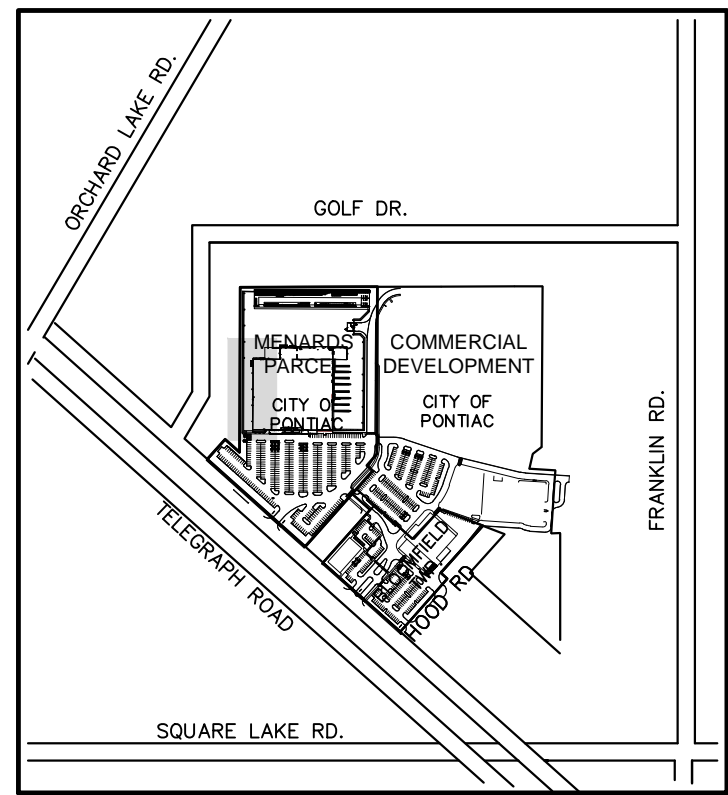
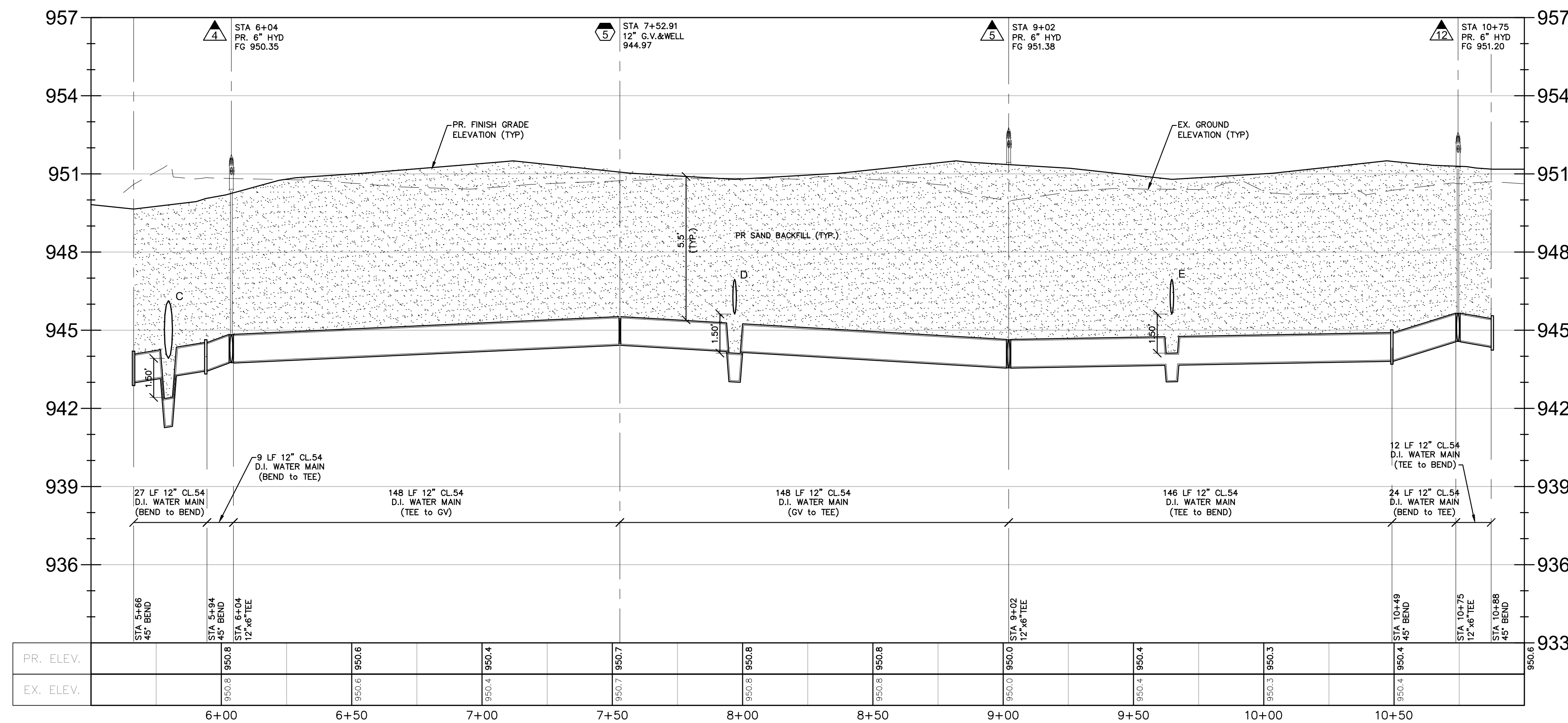

LOCATION MAP
N.T.S.

LEGEND

- | | | |
|-----------------------------|---------------------------|---------------------------|
| CLEAN-OUT | MANHOLE | EXISTING SANITARY SEWER |
| HYDRANT | GATE VALVE | EXISTING WATER MAIN |
| INLET | RYCB | EXISTING STORM SEWER |
| UTILITY POLE | GUY POLE | EXISTING BURIED CABLES |
| EXISTING LIGHT POLE | EXISTING SIGN | EXISTING GAS MAIN |
| PR. SANITARY SEWER | PR. WATER MAIN | PR. STORM SEWER |
| PR. SAND BACKFILL | UTILITY CROSSING | PR. TOP OF CURB ELEVATION |
| PR. TOP OF GUTTER ELEVATION | PR. TOP OF WALK ELEVATION | PR. TOP OF PAVEMENT ELEV. |
| PR. TOP OF FINISH GRADE | PROPOSED FINISH GRADE | PROPOSED CONTOUR |
| PROPOSED SWALE | PR. DRAINAGE DIRECTION | PROPOSED INLET FILTER |
| DRAINAGE AREA LIMITS | PROPOSED SILT FENCE | LIMITS OF SOIL DISRUPTION |

NF
ENGINEERS
CIVIL ENGINEERS
LAND SURVEYORS
LAND PLANNERS

NOWAK & FRAUS ENGINEERS
46777 WOODWARD AVE.
PONTIAC, MI 48342-5032
TEL. (248) 332-7931
FAX. (248) 332-8257

SEAL

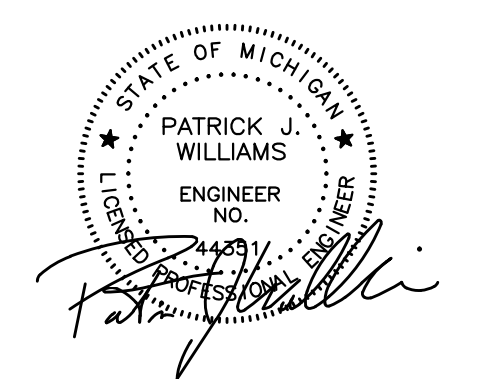

PROJECT

Village at Bloomfield

CLIENT

REDICO
One Towne Square,
Suite 1600
Southfield, MI 48076

Contact:

Phone: (248) 784-6486

PROJECT LOCATION

Part of the W. 1/2 of Section 5,
T. 2N., R. 10E., and part of the
NE 1/4 of Section 6, T. 2N., R.
10E., Bloomfield Township, The
City of Pontiac and Bloomfield
Township (conditionally
transferred to The City of
Pontiac) Oakland County,
Michigan

SHEET

Water Main Plan & Profile
Sta 5+60 to 10+88



Know what's below
Call before you dig.

DATE ISSUED / REVISED

05-12-17 Bids / Permits

DRAWN BY:

A. Wiseman

DESIGNED BY:

A. Wiseman

APPROVED BY:

P. Williams

DATE:

03-16-17

SCALE: 1" = 30'

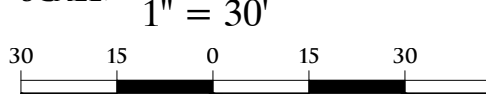

NFE JOB NO.

A116-21

SHEET NO.

C-48